

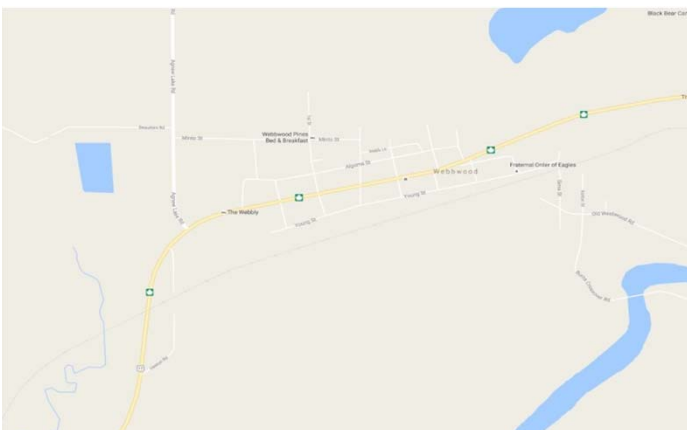

SCHOOL INFORMATION PROFILE



Webbwood P.S.

6 Minto Street, Webbwood, ON P0P 2G0

School Information Profile



Definitions	
ADE	- Average Daily Enrolment - October 31st enrolment x .5 + March 31st enrolment x .5
ASD	– Autism Spectrum Disorder
FCI	- Facilities Condition Index - 5 Year Renewal Requirements / Replacement Cost of an Asset Renewal Requirements in a Given Year = (Current Year Renewal + Backlog)
FTE	- Full Time Equivalent
GFA	- Gross Floor Area - The total floor area of a building including: instructional areas, operational areas, corridors, hallways, entrances, entry vestibules, stairs, refuge areas, and external wall thickness.
IB	- International Baccalaureate Program - This internationally recognized two-year comprehensive program encourages critical thinking and research skills and promotes service as part of the learning process.
ISP	- Intensive Support Program
Intramural Sports	– Recreational sports organized within a school.
OTG	- On-the-ground capacity - The capacity of the school determined by the Ministry of Education by loading all instructional spaces within the facility to current Ministry standards for class size requirements and room areas.
OYAP	- Ontario Youth Apprenticeship Program - a school-to-work transition program offered through Ontario secondary schools. Full-time students in Grades 11 and 12 earn cooperative education credits through work placements in skilled trades. http://www.edu.gov.on.ca/eng/
SHSM	- Specialist High Skills Majors - is a ministry-approved specialized program that allows students to focus their learning on a specific economic sector while meeting the requirements to graduate from secondary school. It also assists in their transition after graduation to apprenticeship training, college, university or the workplace. http://www.edu.gov.on.ca/eng/
SFIS	- School Facilities Inventory System - A web based system that contains key information on the physical inventory of all school facilities in Ontario.
Seminar Room	– An instructional space with an area less than 38 M ² .
Resource Room	– An instructional space with an area between 38 M ² and 64 M ² for special education or resource withdrawal.
TCPS	- Total Capital Planning Solutions - A web based asset management database provided by the Ministry of Education.
Conversion Factors	<p>1 Square Meter (M²) = 10.7639 Square Feet (Ft²)</p> <p>1 Acre = 4046.86 M²</p>

School Information Profile

Elementary



Executive Summary					
School:	Webbwood PS				
Address:	6 Minto Street Webbwood, ON P0P 2G0				
Grade Configuration (e.g., JK-8, 9-12)	Junior Kindergarten to Grade 8				
French Immersion	Y <input type="checkbox"/> N <input checked="" type="checkbox"/>				
Age of Facility:	60				
Year Built:	1956				
Dates of Additions:	1959, 1972, 1990				
Site Size:	30028	M ²			
Building Size - Gross Floor Area	1759	M ²			
OTG Capacity	190				
Facility Condition Index	58%				
Historical ADE	2010/2011	2011/2012	2012/2013	2013/2014	2014/2015
	61	55	51	52	47
Projected ADE 10 Years	2015/2016	2016/2017	2017/2018	2018/2019	2019/2020
	51	50	48	49	52
	2020/2021	2021/2022	2022/2023	2023/2024	2024/2025
	52	52	52	49	50
See Appendix A for projected enrolment by grade and program.					
Utilization %	2015/2016	2016/2017	2017/2018	2018/2019	2019/2020
	27%	26%	25%	26%	27%
	2020/2021	2021/2022	2022/2023	2023/2024	2024/2025
	27%	27%	27%	26%	26%
Surplus / (Shortage) of Pupil Places	2015/2016	2016/2017	2017/2018	2018/2019	2019/2020
	139	140	142	141	138
List of Attachments	Site Plan	<input type="checkbox"/>	Context Map	<input type="checkbox"/>	
	Floor Plan	<input type="checkbox"/>	Planning Map	<input type="checkbox"/>	
	Historical Floor Plan	<input type="checkbox"/>	Official Plan	<input type="checkbox"/>	
	Boundary Map	<input type="checkbox"/>	Zoning Map	<input type="checkbox"/>	



Section 1 : Value to the Students

1.1 Room Inventory Data: Ministry of Educations School Facilities Inventory System 2015 - 2016

Room Number	Space Type	Current Use	Loading	Comments
44	Cafetorium	Administration	0	
10	Classroom	Classroom	23	
41	Classroom	Classroom	23	
11	Classroom	Classroom	23	
12	Classroom	Classroom	23	
23	Classroom	Classroom	23	
24	Classroom	Child Care	23	
25	General Purpose Room	Gymnasium	0	
20	Kindergarten	Senior Kindergarten	26	
21	Kindergarten	Senior Kindergarten	26	
45	Library Resource Centre	Computers	0	
2	Seminar Room	Special Education	0	
17	Staff Work Rm./Lounge	Staff Work/Lounge	0	

1.2 Parking

Number of Spaces	10	
Required Spaces	16	According to Municipal Bylaw

1.3 Site

Separate Bus Layby		Y <input type="checkbox"/> N <input checked="" type="checkbox"/>		
Parent Drop Off Area		Y <input type="checkbox"/> N <input checked="" type="checkbox"/>		
Total Area of Site:			30,028	M ²
Building Area:			1,759	M ²
Play Area:	Hard Surface		1,300	M ²
	Gravel		2,200	M ²
	Grass		5,800	M ²
	Playing Fields		7,200	M ²
Outside Facilities	Y/N	Outside Facilities	Y/N	
Soccer Field	Y <input type="checkbox"/> N <input checked="" type="checkbox"/>	Green Space	Y <input checked="" type="checkbox"/> N <input type="checkbox"/>	
Football Field	Y <input type="checkbox"/> N <input checked="" type="checkbox"/>	Track	Y <input checked="" type="checkbox"/> N <input type="checkbox"/>	
Basketball Court	Y <input checked="" type="checkbox"/> N <input type="checkbox"/>	Baseball Diamond	Y <input checked="" type="checkbox"/> N <input type="checkbox"/>	
Tennis Court	Y <input type="checkbox"/> N <input checked="" type="checkbox"/>	Courtyard	Y <input checked="" type="checkbox"/> N <input type="checkbox"/>	
Play Structure	Y <input checked="" type="checkbox"/> N <input type="checkbox"/>	Greenhouse	Y <input type="checkbox"/> N <input checked="" type="checkbox"/>	
Shaded Area	Y <input checked="" type="checkbox"/> N <input type="checkbox"/>	Other	Y <input type="checkbox"/> N <input type="checkbox"/>	



Section 1 : Value to the Students

1.4 Proximity of School to Students

From 2016/2017 School Year

Transportation

Number of students within walking distance to school	7	
Number of students bussed to school	33	
Number of students out of area, bussed to school	0	
Number of students out of area not bussed to school	0	
Other	5	
Average distance to school for all students	2.1	Km
Average distance to school for students within boundary	2.1	Km

Bus Ride Time	0-15 min	16-30 min	31-45 min	46-60 min	61-75 min
A.M.	26	4	2		
P.M.	17	10	1	3	1
Total	43	14	3	3	1
Percent	67%	22%	5%	5%	2%

Section 1 : Value to the Students

1.5 Accessibility for Individuals with Disabilities

Accessible Element	Yes/No	Accessible Element	Yes/No
Wheelchair Accessible	Y <input checked="" type="checkbox"/> N <input type="checkbox"/>	Shops	Y <input type="checkbox"/> N <input type="checkbox"/>
Washrooms Wheelchair Accessible	Y <input checked="" type="checkbox"/> N <input type="checkbox"/>	Stage	Y <input type="checkbox"/> N <input checked="" type="checkbox"/>
Elevator	Y <input type="checkbox"/> N <input type="checkbox"/>	Bleachers	Y <input type="checkbox"/> N <input type="checkbox"/>
Exterior Ramps	Y <input checked="" type="checkbox"/> N <input type="checkbox"/>	Science labs	Y <input type="checkbox"/> N <input type="checkbox"/>
Interior Ramps	Y <input type="checkbox"/> N <input checked="" type="checkbox"/>	Strips on Stairs	Y <input type="checkbox"/> N <input checked="" type="checkbox"/>
Auto Door Openers	Y <input type="checkbox"/> N <input checked="" type="checkbox"/>	Alarms & Signals	Y <input type="checkbox"/> N <input checked="" type="checkbox"/>
Fountain	Y <input type="checkbox"/> N <input checked="" type="checkbox"/>	Parking with Signs	Y <input checked="" type="checkbox"/> N <input type="checkbox"/>
Playstructure Yard	Y <input type="checkbox"/> N <input checked="" type="checkbox"/>		

1.6 Security

Is the main entry door visible from the main office?	Y <input type="checkbox"/> N <input checked="" type="checkbox"/>
Does the school have video surveillance cameras?	Y <input checked="" type="checkbox"/> N <input type="checkbox"/>
Does the school have controlled access doors?	Y <input checked="" type="checkbox"/> N <input type="checkbox"/>

[illegible]



Section 1 : Value to the Students

1.7.2 Supports

Grade Organization Breakdown For Elementary Schools Contd.

Teacher	JK	SK	1	2	3	4	5	6	7	8	Self Contained	Section	Total
V													0
W													0
X													0
Y													0
Z													0
AA													0
Total	4	6	3	8	4	5	4	2	4	5	0	0	45

How many combined grades does the school have?

1.8.1 Range of Extracurricular Activities - 2016/2017

List intramural sports (boys): [Volleyball](#), [basketball](#), [badminton](#) (these are co-ed)

List intramural sports (girls): [Volleyball](#), [basketball](#), [badminton](#) (these are co-ed)

List co-ed intramural sports: [Volleyball](#), [x-country running](#)

List school sports teams (boys):

List school sports teams (girls):

List co-ed school sports teams: [Volleyball](#), [x-country running](#), [track and field](#)

Clubs. Please list:

1.8.2 Specialized Program Offerings

Does the school have a specialized teacher for:

Instrumental Music	Y <input type="checkbox"/> N <input checked="" type="checkbox"/>	Section	Y <input type="checkbox"/> N <input checked="" type="checkbox"/>
Native Language	Y <input type="checkbox"/> N <input checked="" type="checkbox"/>	Student Success	Y <input type="checkbox"/> N <input checked="" type="checkbox"/>
Intensive Support Program/ASD/Comprehensive	Y <input type="checkbox"/> N <input checked="" type="checkbox"/>	Early Reading Intervention	Y <input type="checkbox"/> N <input checked="" type="checkbox"/>



Section 2 : Value to the Board			
2.1 Major Facility Improvements - 10 Year History (2005 - 2015)			
Year	Type	Brief Description	Cost
	Other	Various replacements, repairs and upgrades under \$100,000	\$ 22,939
Total			\$ 22,939



Section 2 : Value to the Board						
2.2 Major Facility Needs - 5 Year Projection (2015 - 2020)						
Type	Brief Description				Estimated Cost	
Interior/Exterior Doors and Windows	Replace windows, interior and exterior doors.				\$	269,888
Infrastructure	Replace roof coverings, repair exterior walls and parging.				\$	672,281
Interior finishes	Replace millwork, plumbing fixtures, flooring, painting, ceilings, lockers.				\$	464,455
Mechanical	Replace hot water boilers and heating system, domestic water systems, ventilation system, well system, septic system.				\$	1,010,523
Electrical	Replace main switchboard, lighting equipment, and fire alarm system.				\$	228,141
Site Work	Replace site utilities, playing fields, parking lots, , landscaping and roadways.				\$	872,303
Total					\$	3,517,591
2.3 Cost To Operate the School Annually From 2014/2015 School Year						
Annual Energy Consumption	Electricity	212640	kwh	Oil	11986	Liters
	Natural Gas	NA	M ³			
Water/Sewer Use		Well	M ³			
Utility Cost Per M ²					\$	41.36



Section 2 : Value to the Board					
2.4 Community Use					2015 2016
Number of Permits	20	Total Revenue	\$	84.75	Cost Recovery Y <input type="checkbox"/> N <input checked="" type="checkbox"/>
2.5 Non School Programs and Services					
Child Care	Name:	NA			
		Licensed Capacity		Full Cost Recovery	
	Infant			Y <input type="checkbox"/> N <input type="checkbox"/>	
	Toddler			Y <input type="checkbox"/> N <input type="checkbox"/>	
	Pre-School			Y <input type="checkbox"/> N <input type="checkbox"/>	
	JK-SK			Y <input type="checkbox"/> N <input type="checkbox"/>	
School Age (SAC)				Y <input type="checkbox"/> N <input type="checkbox"/>	
Hub	Name:				Full Cost Recovery
	Our Children Our Future				Y <input type="checkbox"/> N <input checked="" type="checkbox"/>
					Y <input type="checkbox"/> N <input type="checkbox"/>
Other Programs	Name:				Full Cost Recovery
	NA				Y <input type="checkbox"/> N <input type="checkbox"/>
					Y <input type="checkbox"/> N <input type="checkbox"/>
					Y <input type="checkbox"/> N <input type="checkbox"/>
Local Partners	Name:				Full Cost Recovery
	NA				Y <input type="checkbox"/> N <input type="checkbox"/>
					Y <input type="checkbox"/> N <input type="checkbox"/>
					Y <input type="checkbox"/> N <input type="checkbox"/>

Appendix A

Webbwood Public School Enrolment at October 31st

[illegible]

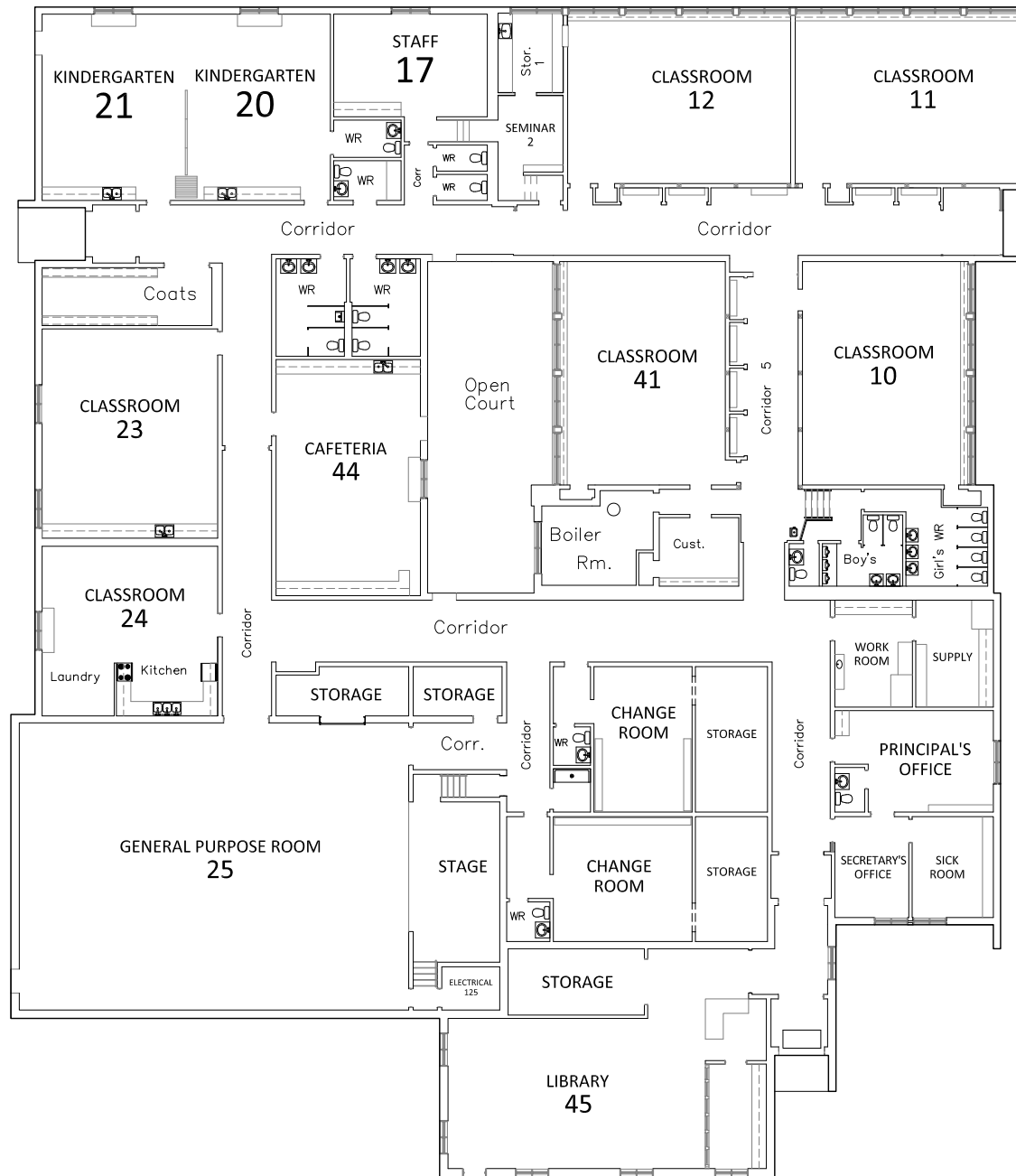

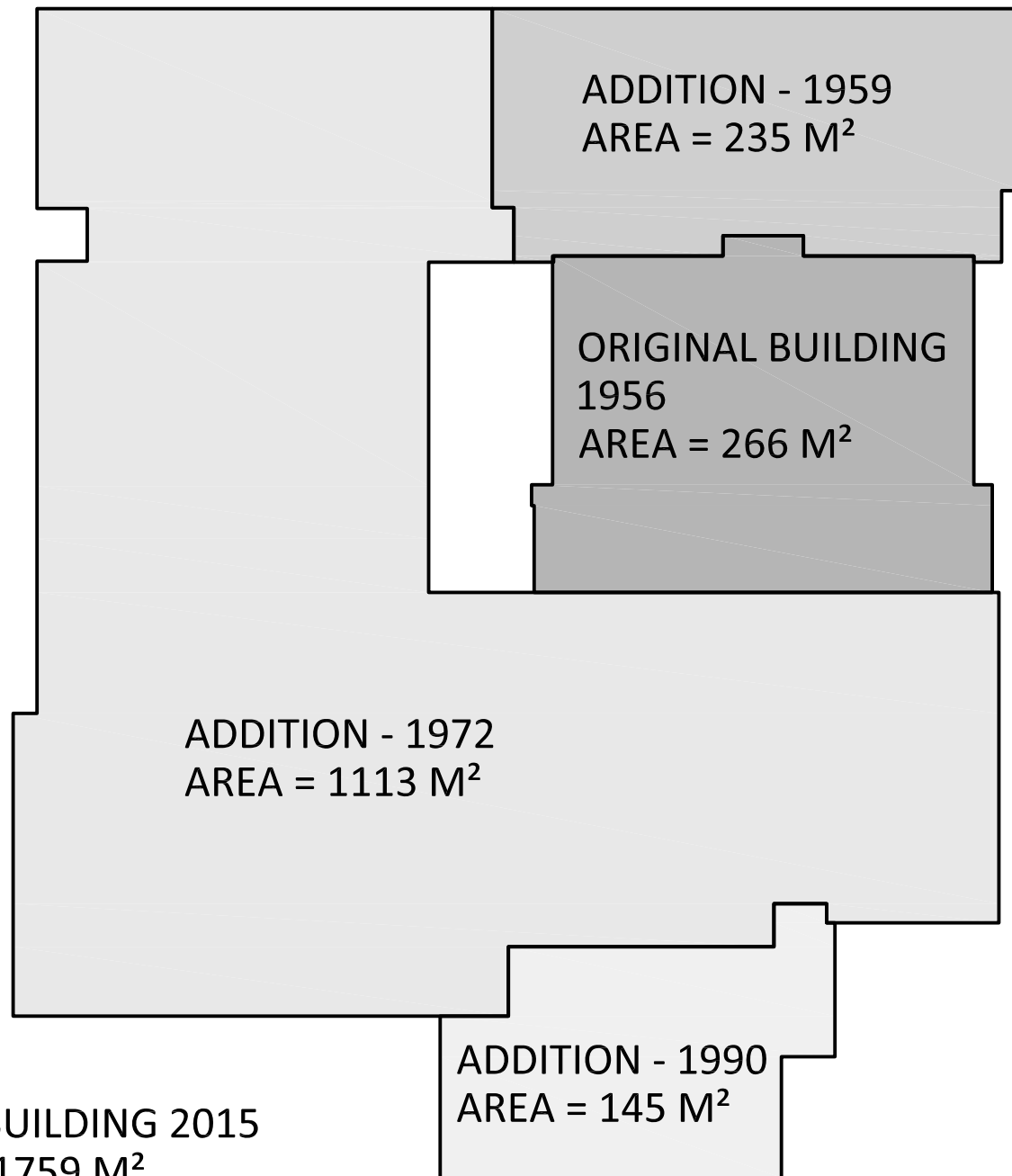

TOTAL BUILDING 2015
AREA = 1759 M²

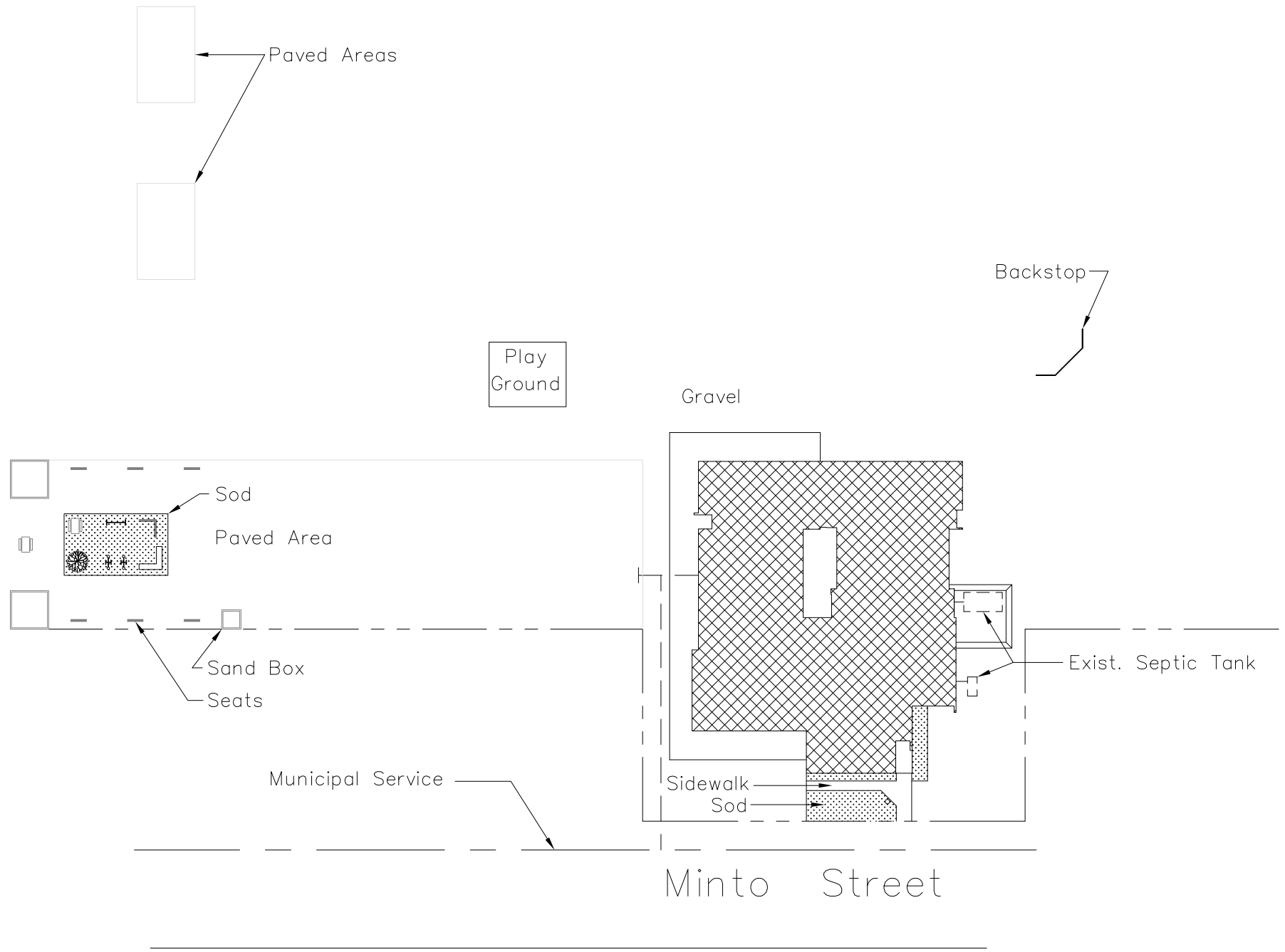



OFFICIAL PLAN FOR THE



SCHEDULE "A3" URBAN SETTLEMENT AREA OF WEBBWOOD

Date: September, 2010

SCALE



Legend

- Land Use Designations**
 - Urban Residential District
 - Hunter District
 - Mobile Home District
 - Commercial District
 - Industrial District
 - Rural District
 - Resource Protection District
 - Subsidence Area
 - Mineral Aggregate Resources
 - Areas of Primary Significance
 - Licensed Resources (LIR)
 - Unlicensed Resources (ULR)
 - Mineral Aggregates (Vigilance Districts)
 - Environmental Protection Area
 - Commercial Improvement Area Boundary
 - Water District Facility
 - 600m Influence Area (Approximate)
- Mineral Resource Constraint Overlay**
 - Mine Hazards
 - Low Mineral Potential / Medium to High Mineral Potential
 - Mining Operation on Crown Lands
- Natural Heritage Features**
 - Fish Spawning Area
 - Deer Yard/Spawning Area
 - Moose Aquatic Feeding Area
 - Moose Lake Spawning Area
 - Sigbee's Ecological Area
 - Ontario's Living Legacy Features
- Transportation and Infrastructure**
 - Proposed Highway
 - Township Roads (Twelve Mile Road)
 - Township Roads (Seasonally Maintained)
 - Private Roads
 - Resource Access Roads
 - Rail
 - Transitway Line
 - Rail Line
 - Serviceable Road
- Other Features**
 - Township Boundary
 - Urban Settlement Boundary
 - Cemetery
 - Crown Land
 - Organic Soils
 - Potentially Contaminated Sites

Source: or Information
Ontario Geological Survey Map No. 6008
Ontario Geological Survey Map No. 6008
Abandoned Mines Information System (AMIS)
Flood Elevation of Spanish River to 177.20m.



WEBBWOOD PS

